

COPYRIGHT
THIS DOCUMENT AND ALL DATA CONTAINED HEREIN REMAIN THE PROPERTY OF O'DALY ARCHITECTS. IT IS SUPPLIED IN CONFIDENCE FOR EVALUATION PURPOSES ONLY UNDER THE CONDITION THAT SAME IS NOT USED, REPRODUCED OR TRANSMITTED IN ANY WAY TO OTHERS WITHOUT WRITTEN CONSENT.

DIMENSIONS
UNLESS OTHERWISE STATED, DIMENSIONS SHOWN ARE IN MILLIMETRES. NO DIMENSIONS TO BE SCALED FROM THIS DRAWING. ALL DIMENSIONS TO BE CHECKED BY THE CONTRACTOR ON SITE AND ANY DISCREPANCIES TO BE REPORTED TO THE ARCHITECT.

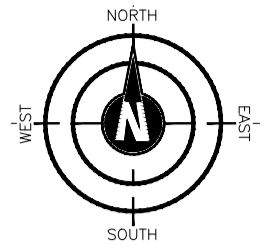

LEGEND

- PEDESTRIAN PERMEABILITY LINES (NEW PATH NETWORK) ———
- CONNECTION POINTS (Proposed & Potential) ➔
- RAISED TABLE CROSSING POINTS

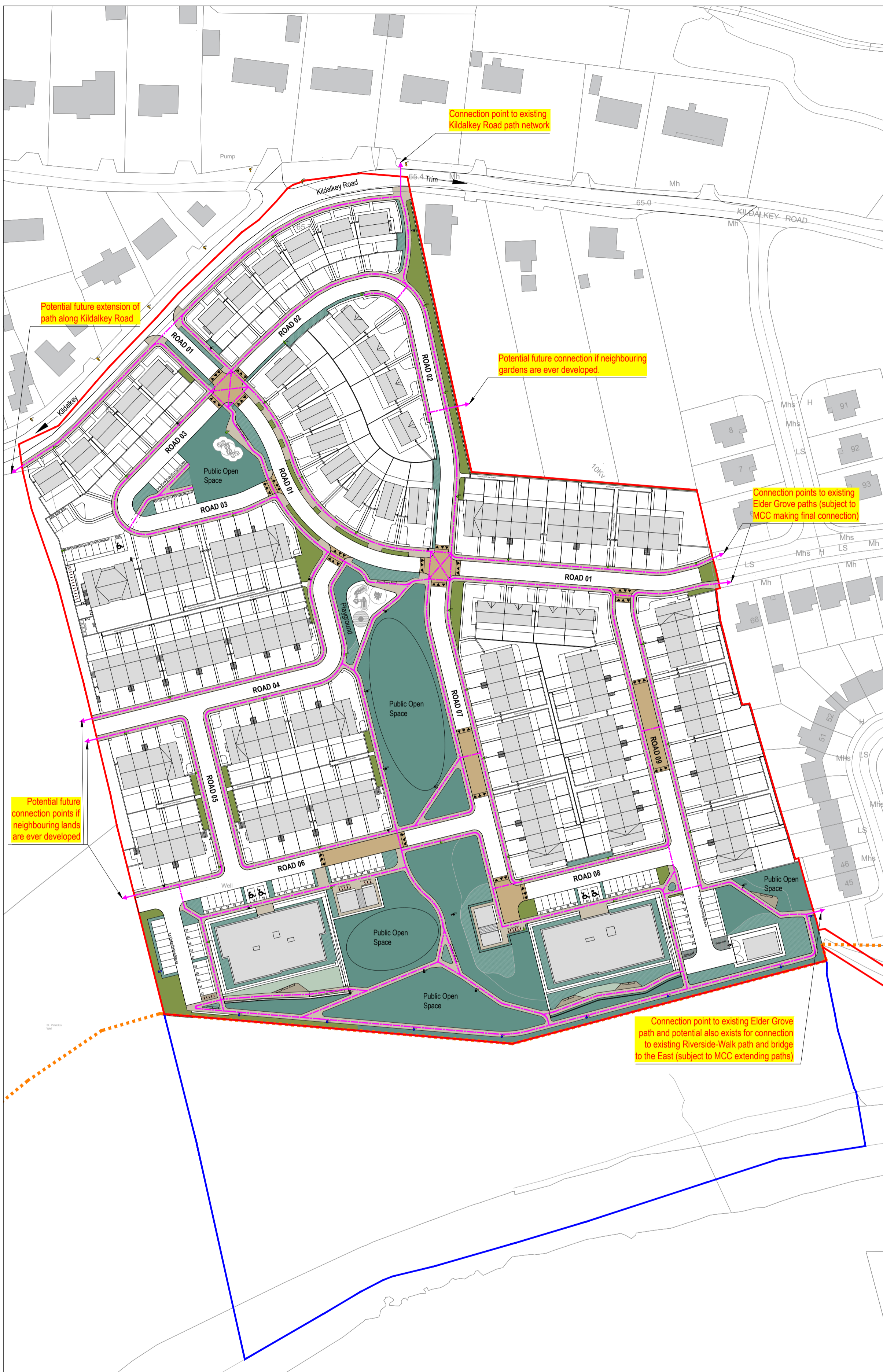

PROPOSED SITE LAYOUT PLAN (PERMEABILITY & CONNECTIVITY PLAN)
SCALE 1:1,000

O.S. Ref. 2710-D
GROSS AREA OF SITE EDGED RED = 6.087 HA
NET DEVELOPMENT AREA (NDA) OF SITE = 5.648 HA
183 RESIDENTIAL UNITS PROPOSED (127 HOUSES + 56 APARTMENTS)
PROPOSED DENSITY = 32.40 DPH
PROPOSED PUBLIC OPEN SPACE PROVISION (8,842m²) = 15.65% NDA

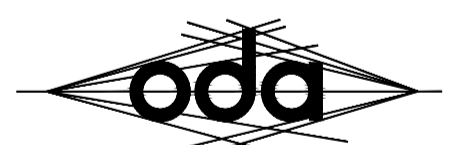

o'daly architects

1st Floor - Unit 13(B) - Mullaghboy Industrial Estate
Navan - County Meath - Tel: (046) 9021283
Mobile: (087) 0925233 - Email: ivan@odaly.ie

RIAI Registered Architect 2026	RIAI Practice Member 2026
---	--

Client:
Loughglynn Developments Ltd.

Project Name and Address:
Proposed Large Residential Development (LRD) at "Crowpark 1st Division", Kildalkey Road, Trim, County Meath.

Project Stage:
Planning

Drawing Name:
Proposed Site Layout Key Plan (1:1000)
Permeability & Connectivity Plan

Drawn By: iod	Scale: 1:1000 @ A2
Checked By: iod	Date: 04.06.2026

Drawing Number: 24004-AR-122	Revision: P01
--	-------------------------